

CODE NO.	PART NO.	DESCRIPTION AND MODELS	PER CAR
CARRIER			
12.000		BEARING - DIFFERENTIAL	
	311992	1951-2003-06-2103-06-26-30	2
	348642	2000-01-10-11-2100-01-11	2
12.0005		ADJUSTING NUT - DIFFERENTIAL BEARING	
	311919	1951-2003-06-2103-06-26-30	2
	329266	2000-01-10-11-2100-01-11	2
	6886	Cotter pin 7/32 x 3/4, 1951-2000-01-03-06-10-11-2100-01-03-06-11-26-30	2
12.001		CARRIER ASSEMBLY - DIFFERENTIAL	
		Standard Without Overdrive	
	901094	4.09 to 1, 1951	1
	901043	4.3 to 1, 2000-10-2100	1
	901047	4.1 to 1, 2001-11-2101-11	1
	901051	3.92 to 1, 2003-06-2103-06	1
	901262	4.09 to 1, 2126	1
		Standard With Overdrive	
	900053	4.36 to 1, 1951	1
	901044	4.55 to 1, 2000-10-2100	1
	901049	4.09 to 1, 2003-06-2103-06	1
	901043	4.3 to 1, 2001-11-2101-11	1
	901048	4.36 to 1, 2126	1
		Special Without Overdrive	
	900053	4.36 to 1, 1951	1
	901098	4.54 to 1, 1951	1
	901044	4.55 to 1, 2000-10-2100	1
	901049	4.09 to 1, 2003-06-2103-06	1
	901048	4.36 to 1, 2003-06-2103-06	1
	901043	4.3 to 1, 2001-11-2101-11	1
		Special With Overdrive	
	901098	4.54 to 1, 1951	1
	901048	4.36 to 1, 2003-06-2103-06	1
	348078	Bolt 3/8-24 x 1-3/16, to case, (50.092) 1951-2000-01-03-06-10-11-2100-01-03-06-11-26-30	9
	237673	Gasket, to case bolt, (50.660) 1951-2000-01-03-06-10-11-2100-01-03-06-11-26-30	9
	348079	Lock nut, 1951-2000-01-03-06-10-11-2100-01-03-06-11-26-30	9
	6099	Oil plug 1/2 sq. head, 1951-2000-01-03-06-10-11-2100-01-03-06-11-26-30	2
12.0015		CARRIER AND CAP ASSEMBLY - DIFFERENTIAL	
	319966	1951	1
	347046	2000-01-10-11-2100-01-11	1
	347393	not used with 3.92 to 1 ratio, 2003-06-2103-06-26-30	1
	347391	used only with 3.92 to 1 ratio, 2003-06-2103-06	1
12.002		CAP - DIFFERENTIAL CARRIER	
	311920	1951-2003-06-2103-06-26-30	2
	329310	2000-01-10-11-2100-01-11	2

CODE NO.	PART NO.	DESCRIPTION AND MODELS	PER CAR
CARRIER-Continued			
12.002		CAP - DIFFERENTIAL CARRIER (Cont'd)	
	329257	Screw 1/2-20 x 2-1/2 (50.003) 2000-01-10-11-2100-01-11	4
	329484	Screw lock, 2000-01-10-11-2100-01-11	4
	330109	Stud 1/2, 1951-2003-06-2103-06-26-30	4
	7161	Nut 1/2-20, stud, (50.120) 1951-2003-06-2103-06-26-30	4
12.003		GASKET - DIFFERENTIAL CARRIER TO CASE	
	323010	1951-2003-06-2103-06-26-30	1
	334889	2000-01-10-11-2100-01-11	1
12.004		CASE - DIFFERENTIAL	
	347830	1951	1
	360399	not used with 4.1 to 1 ratio, 2000-01-10-11-2100-01-11	1
	373314	used with 4.1 to 1 ratio, 2001-11-2101-11	1
	347830	not used with 3.92 to 1 ratio, 2003-06-2103-06-26-30	1
	347800	used with 3.92 to 1 ratio, 2003-06-2103-06	1
12.005		GEAR AND PINION ASSEMBLY - DIFFERENTIAL DRIVING	
		Standard Without Overdrive	
	900065	4.09 to 1, 1951-2126	1
	900023	4.3 to 1, 2000-10-2100	1
	901042	4.1 to 1, 2001-11-2101-11	1
	900131	3.92 to 1, 2003-06-2103-06	1
		Standard With Overdrive	
	900064	4.36 to 1, 1951-2126	1
	900024	4.55 to 1, 2000-10-2100	1
	900023	4.3 to 1, 2001-11-2101-11	1
	900065	4.09 to 1, 2003-06-2103-06	1
		Special Without Overdrive	
	900064	4.36 to 1, 1951-2003-06-2103-06	1
	900066	4.54 to 1, 1951	1
	900024	4.55 to 1, 2000-10-2100	1
	900023	4.3 to 1, 2001-11-2101-11	1
	900065	4.09 to 1, 2003-06-2103-06	1
		Special With Overdrive	
	900066	4.54 to 1, 1951	1
	900064	4.36 to 1, 2003-06-2103-06	1
	329373	Screw 3/8-24 x 25/32 (50.003) 2000-01-10-11-2100-01-11	12
	347824	Screw 7/16-20 x 15/16 hex. hd., 1951-2003-06-2103-06-26-30	12
	120813	Lockwire 7" long, 1951-2000-01-03-06-10-11-2100-01-03-06-11-26-30	6
12.006		IDLER - DIFFERENTIAL DRIVING GEAR	
	323379	2003-06-2103-06-26-30	1
12.007		LOCKING PLATE - DIFFERENTIAL DRIVING GEAR IDLER	
	323352	2003-06-2103-06-26-30	1

CODE NO.	PART NO.	DESCRIPTION AND MODELS	PER CAR	CODE NO.	PART NO.	DESCRIPTION AND MODELS	PER CAR
CARRIER				CARRIER-Continued			
12.000		BEARING - DIFFERENTIAL		12.002		CAP - DIFFERENTIAL CARRIER (Cont'd)	
	311992	1951-2003-06-2103-06-26-30	2	329257		Screw 1/2-20 x 2-1/2 (50.003) 2000-01-10-11-2100-01-11	4
	348642	2000-01-10-11-2100-01-11	2	329484		Screw lock, 2000-01-10-11-2100-01-11	4
12.0005		ADJUSTING NUT - DIFFERENTIAL BEARING		330109		Stud 1/2, 1951-2003-06-2103-06-26-30	4
	311919	1951-2003-06-2103-06-26-30	2	7161		Nut 1/2-20, stud, (50.120) 1951-2003-06-2103-06-26-30	4
	329266	2000-01-10-11-2100-01-11	2				
	6886	Cotter pin 7/32 x 3/4, 1951-2000-01-03-06-10-11-2100-01-03-06-11-26-30	2	12.003		GASKET - DIFFERENTIAL CARRIER TO CASE	
*12.001		CARRIER ASSEMBLY - DIFFERENTIAL		323010		1951-2003-06-2103-06-26-30	1
		Standard Without Overdrive		334889		2000-01-10-11-2100-01-11	1
	901094	4.09 to 1, 1951	1	12.004		CASE - DIFFERENTIAL	
	901043	4.3 to 1, 2000-10-2100	1	347830		1951	1
	901047	4.1 to 1, 2001-11-2101-11	1	360399		not used with 4.1 to 1 ratio, 2000-01-10-11-2100-01-11	1
	901051	3.92 to 1, 2003-06-2103-06	1	373314		used with 4.1 to 1 ratio, 2001-11-2101-11.	1
	901262	4.09 to 1, 2126	1	347830		not used with 3.92 to 1 ratio, 2003-06-2103-06-26-30	1
		Standard With Overdrive		347800		used with 3.92 to 1 ratio, 2003-06-2103-06	1
	900053	4.36 to 1, 1951	1	*12.005		GEAR AND PINION ASSEMBLY - DIFFERENTIAL DRIVING	
	901044	4.55 to 1, 2000-10-2100	1			Standard Without Overdrive	
	901049	4.09 to 1, 2003-06-2103-06	1	900065		4.09 to 1, 1951-2126	1
	901043	4.3 to 1, 2001-11-2101-11	1	900023		4.3 to 1, 2000-10-2100	1
	901048	4.36 to 1, 2126	1	901042		4.1 to 1, 2001-11-2101-11	1
		Special Without Overdrive		900131		3.92 to 1, 2003-06-2103-06	1
	900053	4.36 to 1, 1951	1			Standard With Overdrive	
	901098	4.54 to 1, 1951	1	900064		4.36 to 1, 1951-2126	1
	901044	4.55 to 1, 2000-10-2100	1	900024		4.55 to 1, 2000-10-2100	1
	901049	4.09 to 1, 2003-06-2103-06	1	900023		4.3 to 1, 2001-11-2101-11	1
	901048	4.36 to 1, 2003-06-2103-06	1	900065		4.09 to 1, 2003-06-2103-06	1
	901043	4.3 to 1, 2001-11-2101-11	1			Special Without Overdrive	
		Special With Overdrive		900064		4.36 to 1, 1951-2003-06-2103-06	1
	901098	4.54 to 1, 1951	1	900066		4.54 to 1, 1951	1
	901048	4.36 to 1, 2003-06-2103-06	1	900024		4.55 to 1, 2000-10-2100	1
	348078	Bolt 3/8-24 x 1-3/16, to case, (50.092) 1951-2000-01-03-06-10-11-2100-01-03-06-11-26-30	9	900023		4.3 to 1, 2001-11-2101-11	1
	237673	Gasket, to case bolt, (50.660) 1951-2000-01-03-06-10-11-2100-01-03-06-11-26-30	9	900065		4.09 to 1, 2003-06-2103-06	1
	348079	Lock nut, 1951-2000-01-03-06-10-11-2100-01-03-06-11-26-30	9			Special With Overdrive	
	6099	Oil plug 1/2 sq. head, 1951-2000-01-03-06-10-11-2100-01-03-06-11-26-30	2	900066		4.54 to 1, 1951	1
				900064		4.36 to 1, 2003-06-2103-06	1
12.0015		CARRIER AND CAP ASSEMBLY - DIFFERENTIAL		329373		Screw 3/8-24 x 25/32 (50.003) 2000-01-10-11-2100-01-11	12
	319966	1951	1	347824		Screw 7/16-20 x 15/16 hex. hd., 1951-2003-06-2103-06-26-30	12
	347046	2000-01-10-11-2100-01-11	1	120813		Lockwire 7" long, 1951-2000-01-03-06-10-11-2100-01-03-06-11-26-30	6
	347393	not used with 3.92 to 1 ratio, 2003-06-2103-06-26-30	1	12.006		IDLER - DIFFERENTIAL DRIVING GEAR	
	347391	used only with 3.92 to 1 ratio, 2003-06-2103-06	1	323379		2003-06-2103-06-26-30	1
12.002		CAP - DIFFERENTIAL CARRIER		12.007		LOCKING PLATE - DIFFERENTIAL DRIVING GEAR IDLER	
	311920	1951-2003-06-2103-06-26-30	2	323352		2003-06-2103-06-26-30	1
	329310	2000-01-10-11-2100-01-11	2				

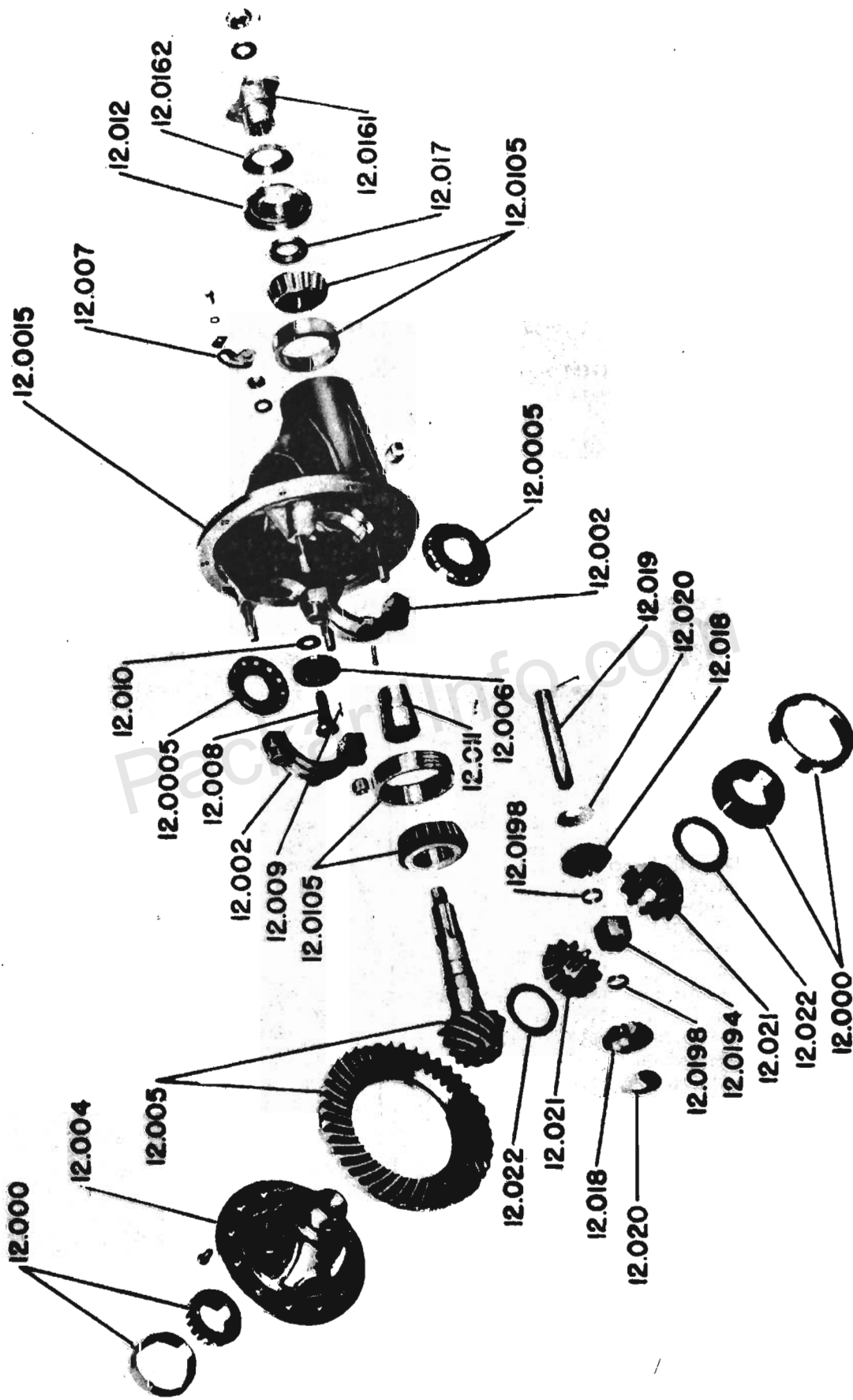

DIFFERENTIAL CARRIER

CODE NO.	PART NO.	DESCRIPTION AND MODELS	PER CAR	CODE NO.	PART NO.	DESCRIPTION AND MODELS	PER CAR
CARRIER—Continued				CARRIER—Continued			
12.007		LOCKING PLATE - DIFFERENTIAL DRIVING GEAR IDLER (Cont'd)		12.017		SPACER - DIFFERENTIAL DRIVING PINION UNIVERSAL JOINT FLANGE	
6185		Screw 5/16-18 x 5/8 (50.003) 2003-06-2103-06-26-30	1	309519		1951-2003-06-2103-06-26-30	1
323469		Washer, 2003-06-2103-06-26-30	1	12.018		PINION - DIFFERENTIAL	
5504		Lockwasher 5/16 (50.220) 2003-06-2103-06-26-30	1	302229		1951	2
12.008		SHAFT - DIFFERENTIAL DRIVING GEAR IDLER		360395		2000-01-10-11-2100-01-11	2
323435		2003-06-2103-06-26-30	1	338909		2003-06-2103-06-26-30	2
5512		Lockwasher 9/16 (50.220) 2003-06-2103-06-26-30	1	12.019		PIN - DIFFERENTIAL PINION	
7933		Check nut 9/16-18 (50.100) 2003-06-2103-06-26-30	1	300729		1951-2003-06-2103-06-26-30	1
12.009		ROLLER - DIFFERENTIAL DRIVING GEAR IDLER SHAFT BEARING		360397		2000-01-10-11-2100-01-11	1
323436		2003-06-2103-06-26-30	28	302560		Lock pin (50.800) 1951-2000-01-03-06-10-11-2100-01-03-06-11-26-30	1
12.010		WASHER - DIFFERENTIAL DRIVING GEAR IDLER SHAFT THRUST		12.0194		THRUST BLOCK - DIFFERENTIAL AXLE SHAFT	
323428		2003-06-2103-06-26-30	1	323133		1951-2003-06-2103-06-26-30	1
12.0105		BEARING - DIFFERENTIAL DRIVING PINION		360401		2000-01-10-11-2100-01-11	1
311990		front, 1951-2003-06-2103-06-26-30	1	12.0198		SPACER - DIFFERENTIAL AXLE SHAFT THRUST BLOCK	
348643		front, 2000-01-10-11-2100-01-11-30	1	323132		1951-2003-06-2103-06-26-30	2
387799		rear, 1951-2003-06-2103-06-26-30	1	360403		2000-01-10-11-2100-01-11	2
387798		rear, 2000-01-10-11-2100-01-11	1	12.020		THRUST WASHER - DIFFERENTIAL PINION	
12.011		SLEEVE - DIFFERENTIAL DRIVING PINION BEARING		300897		1951-2003-06-2103-06-26-30	2
341792		1951-2003-06-2103-06-26-30	1	360405		2000-01-10-11-2100-01-11	2
347051		2000-01-10-11-2100-01-11	1	12.021		GEAR - DIFFERENTIAL	
12.012		OIL SEAL ASSEMBLY - DIFFERENTIAL DRIVING PINION BEARING FRONT		302230		1951	2
311926		1951-2003-06-2103-06-26-30	1	329599		2000-01-10-11-2100-01-11	2
329655		2000-01-10-11-2100-01-11	1	338916		2003-06-2103-06-26-30	2
12.0161		UNIVERSAL JOINT FLANGE - DIFFERENTIAL DRIVING PINION		12.022		THRUST WASHER - DIFFERENTIAL GEAR	
302868		used with Mechanics Propeller shaft, 1951-2000-01-03-06-10-11-2100-01-03-06-11-26-30	1	302228		.031 thick, 1951-2003-06-2103-06-26-30	2
326870		used with Universal Products Propeller shaft, used with overdrive, 2000-01-10-11	1	324583		.036 thick, 1951-2003-06-2103-06-26-30	2
300910		Washer 3/4 (50.200) 1951-2000-01-03-06-10-11-2100-01-03-06-11-26-30	1	324584		.041 thick, 1951-2003-06-2103-06-26-30	2
371683		Nut 3/4-16, 1951-2000-01-03-06-10-11-2100-01-03-06-11-26-30	1	324585		.046 thick, 1951-2003-06-2103-06-26-30	2
12.0162		DUST SHIELD - DIFFERENTIAL DRIVING PINION UNIVERSAL JOINT FLANGE		378688		.031 thick, 2000-01-10-11-2100-01-11	2
309525		1951-2000-01-03-06-10-11-2100-01-03-06-11-26-30	1	382856		.036 thick, 2000-01-10-11-2100-01-11	2
				382857		.041 thick, 2000-01-10-11-2100-01-11	2
				382858		.046 thick, 2000-01-10-11-2100-01-11	2
				CASE and SHAFT			
				12.023		CASE ASSEMBLY	
				373491		1951-2003-06-2103-06-26-30	1
				373941		2000-01-10-11-2100-01-11	1
				12.0235		CLIP - CASE BRAKE TUBE	
				316673		1951-2000-01-03-06-10-11-2100-01-03-06-11-26-30	2
				12.029		SHAFT	
				340110		2000-01-10-11-2100-01-11	2
				323143		1951-2003-06-2103-06-26-30	2
				3893		Washer 3/4 (50.200) 2000-01-10-11-2100-01-11	2

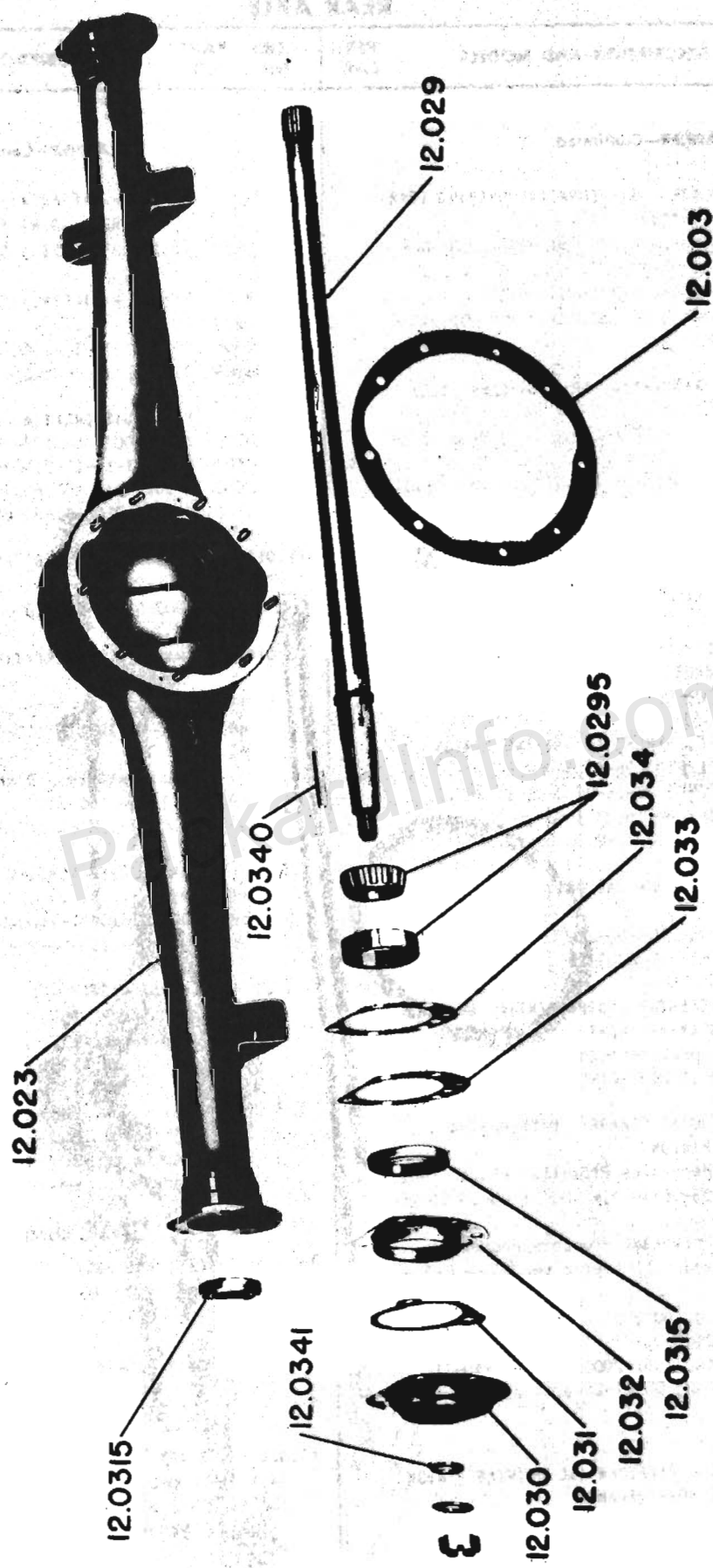

REAR AXLE AND CASE

CODE NO.	PART NO.	DESCRIPTION AND MODELS	PER CAR	CODE NO.	PART NO.	DESCRIPTION AND MODELS	PER CAR
CASE and SHAFT—Continued.							
12.029	SHAFT (Cont'd)						
126985	Washer 7/8 (50.200)	1951-2003-06-2103-06-26-30	2				
351531	Nut 3/4-16 (50.110)	2000-01-10-11-2100-01-11	2				
303913	Nut 7/8-14 (50.110)	1951-2003-06-2103-06-26-30	2				
4309	Cotter pin 1/8 x 1-3/8 (50.240)	2000-01-10-11-2100-01-11	2				
4334	Cotter pin 3/16 x 1-3/4 (50.240)	1951-2003-06-2103-06-26-30	2				
12.0295	BEARING - SHAFT						
348645		2000-01-10-11-2100-01-11	2				
324946		1951-2003-06-2103-06-26-30	2				
12.030	GUARD - SHAFT BEARING OIL						
334922		2000-01-10-11-2100-01-11	2				
323137		1951-2003-06-2103-06-26-30	2				
12.031	GASKET - SHAFT BEARING OIL GUARD						
354267		2000-01-10-11-2100-01-11	2				
354414		1951-2003-06-2103-06-26-30	2				
12.0313	OIL SEAL KIT - SHAFT						
379826	1 wheel,	1951-2003-06-2103-06-26-30	2				
379825	1 wheel,	2000-01-10-11-2100-01-11	2				
379822	2 wheel,	2000-01-10-11-2100-01-11	1				
379823	2 wheel,	1951-2003-06-2103-06-26-30	1				
12.0315	OIL SEAL - SHAFT BEARING						
384121	inner,	2000-01-10-11-2100-01-11	2				
384215	inner,	1951-2003-06-2103-06-26-30	2				
334929	outer,	2000-01-10-11-2100-01-11	2				
324961	outer,	1951-2003-06-2103-06-26-30	2				
12.032	RETAINER - SHAFT BEARING OIL SEAL						
323136		1951-2003-06-2103-06-26-30	2				
12.033	GASKET - SHAFT BEARING OIL SEAL RETAINER						
354409		1951-2003-06-2103-06-26-30	2				
354411		2000-01-10-11-2100-01-11	2				
12.034	SHIM - SHAFT BEARING						
329627	.005,	2000-01-10-11-2100-01-11	x				
323140	.005,	1951-2003-06-2103-06-26-30	x				
329628	.007,	2000-01-10-11-2100-01-11	x				
323141	.007,	1951-2003-06-2103-06-26-30	x				
329629	.020,	2000-01-10-11-2100-01-11	x				
323142	.020,	1951-2003-06-2103-06-26-30	x				
12.0340	KEY - SHAFT						
334921		2000-01-10-11-2100-01-11	2				
197130		1951-2003-06-2103-06-26-30	2				
12.0341	SEAL - SHAFT NUT OIL						
354504		1951-2003-06-2103-06-26-30	2				